

Centrifugal Monoblock Pumps

CT SERIES



DESCRIPTION

C.R.I. Centrifugal Monoblock pump's volute chamber and impellers are carefully designed to give the best possible hydraulic efficiency and suction lift characteristics. Most modern and highly sophisticated machinery and technology are employed in the manufacture of these pumps using quality raw material, dynamically balanced impellers, seals and ball bearings to ensure long life. Dynamically balanced rotor ensure vibration and noise free operations. Shaft is made of quality steel, precision ground of ample size for transmitting the rated Horse power.

SPECIFICATIONS

Power range	:	0.37kW-2.2kW, Single Phase & Three Phase
Speed	:	2900 rpm
Degree of protection	:	IP 44 / IP 54
Class of insulation	:	'B' / 'F'
Versions	:	Single phase - 230V, 50Hz A.C. supply (Permanent Split Capacitor-PSC) Incorporated with thermal overload protector Three phase - 380-415V, 50Hz A.C. supply
Type of Duty	:	S1 (Continuous)
Direction of Rotation	:	Clockwise viewed from driving end
Nominal Delivery Size	:	1" to 3"
Nominal Suction Size	:	1" to 3"
Connection	:	Screw / Flange type (BSP)

MATERIALS OF CONSTRUCTION

Pump casing	:	Cast Iron
Motor frame	:	Aluminium
Impeller	:	Brass / Cast Iron / S.S
Shaft	:	S.S 410 / S.S 304 + Carbon Steel
Sealing	:	Mechanical Seal (Carbon & Ceramic)

PUMP OPERATING LIMITS

Maximum Head	:	51m / 167 ft
Maximum Suction Lift	:	Upto 7m
Maximum Liquid Temperature	:	40°C
Maximum Ambient Temperature	:	55°C

FEATURES

- High operating efficiency resulting in lower power consumption.
- Good suction lift characteristics.
- Dynamically balanced rotating parts.
- Balanced and rigid construction.
- Inbuilt thermal overload protector in all single phase pumps

APPLICATIONS

Residential, Irrigation, Farms, Industrial Water Supply, General Water Supply, Drip & Sprinkler Systems and Water treatment plants.

PERFORMANCE CURVES

CT SERIES

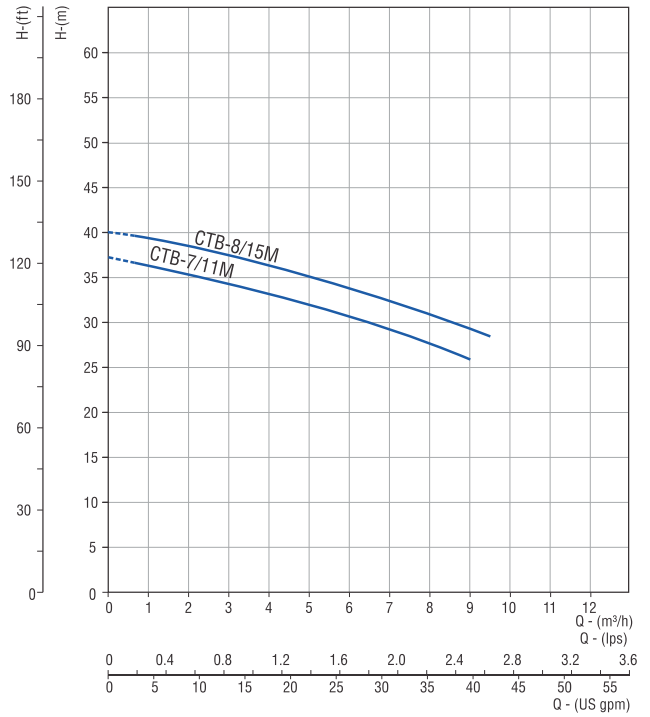
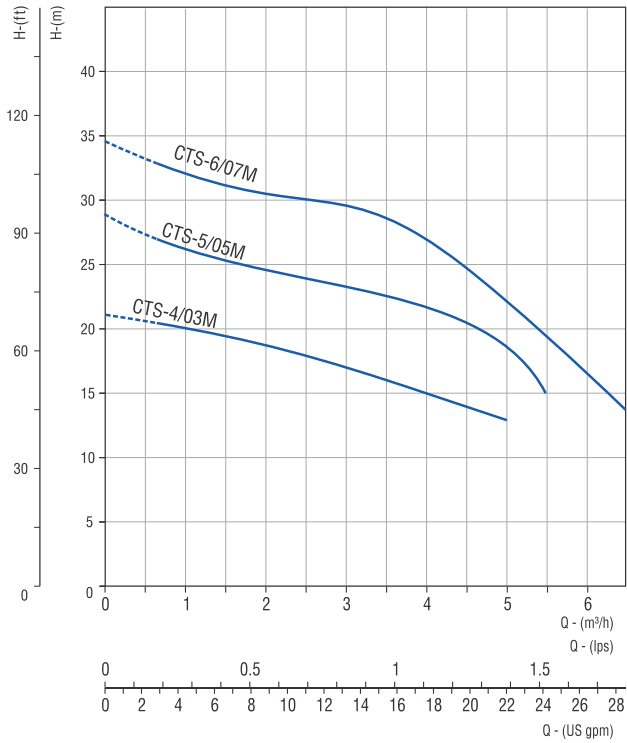

PERFORMANCE CHARTS

PUMP MODEL	MOTOR POWER		NOMINAL PUMP SIZE IN INCHES (Suc x Del)	DISCHARGE IN lps / m³/h											
				0	0.3	0.6	0.8	1.1	1.4	1.7	1.9	2.2	2.5		
				0	1	2	3	4	5	6	7	8	9		
				TOTAL HEAD IN METRES											
CTS-4/03M	0.37	0.5	1 x 1	21	20	19	17.5	15	13						
CTS-5/05M	0.55	0.75	1 x 1	28.5	26.5	24.5	23.5	21.5	19	15 (5.5m³/h)					
CTS-6/07M	0.75	1.0	1 x 1	35	32	31	29.5	27	22	16.5	14 (6.5m³/h)				

PUMP MODEL	MOTOR POWER		NOMINAL PUMP SIZE IN INCHES (Suc x Del)	DISCHARGE IN lps / m³/h											
				0	0.6	0.8	1.1	1.4	1.7	1.9	2.2	2.5	2.7		
				0	2	3	4	5	6	7	8	9	9.5		
				TOTAL HEAD IN METRES											
CTB-7/11M	1.1	1.5	1 x 1	36.5	34.5	33.5	32.5	31.5	30.5	29	27.5	26			
CTB-8/15M	1.5	2	1¼ x 1	40	38	37	36	35	34	33	31	29.5	28.5		

Note : The given performance data are common for both single phase & three phase. The last digit of the pump models "M" denotes Single phase and it will be replaced with "T" in case of three phase. In view of continuous developments the information / performance / descriptions / specifications / illustrations are subject to change without notice.

PERFORMANCE CURVES

CT SERIES

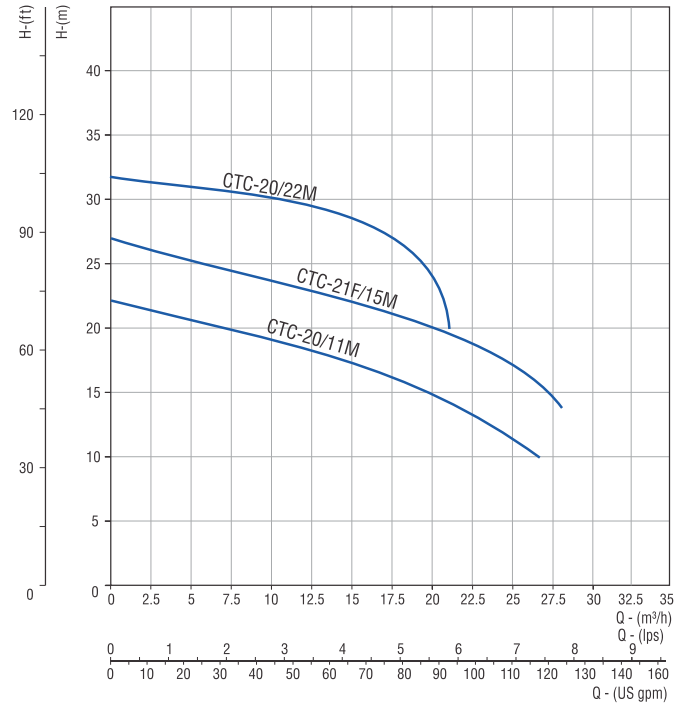
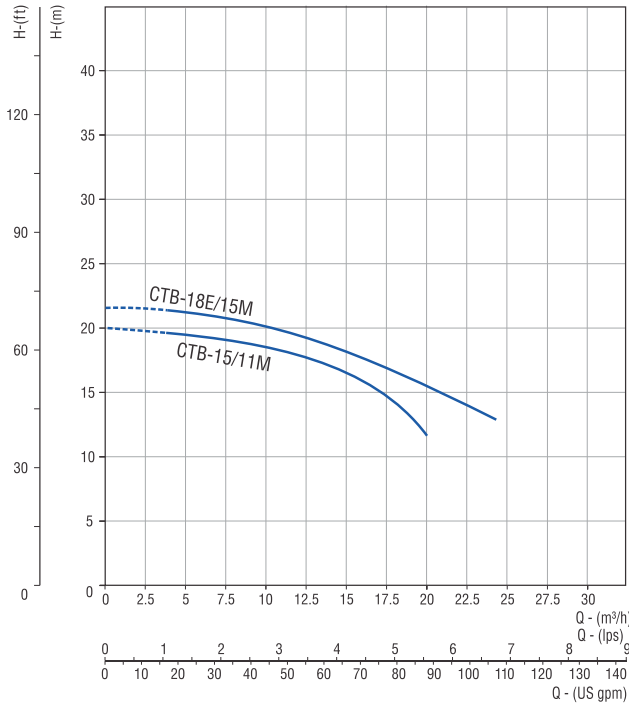

PERFORMANCE CHARTS

PUMP MODEL	MOTOR POWER		NOMINAL PUMP SIZE IN INCHES (Suc x Del)	DISCHARGE IN lps / m³/h									
				0	1.4	2.1	2.8	3.5	4.2	5.6	6.9	8.3	
				0	5	7.5	10	12.5	15	20	25	30	
TOTAL HEAD IN METRES													
CTB-15/11M	1.1	1.5	2 x 2	20	19.5	19	18.5	18	17	12			
CTB-18E/15M	1.5	2.0	2 x 2	21.5	21	20.5	20	19.5	18	17	13 (24m³/h)		

PUMP MODEL	MOTOR POWER		NOMINAL PUMP SIZE IN INCHES (Suc x Del)	DISCHARGE IN lps / m³/h										
				0	2.8	3.3	3.9	4.4	5.0	5.6	6.1	6.7	7.2	7.8
				0	10	12	14	16	18	20	22	24	26	28
TOTAL HEAD IN METRES														
CTC-20/11M*	1.1	1.5	2 x 1½	22	19.2	18	17.7	17	16	15	13.6	12.5	10.4	-
CTC-21F/15M*	1.5	2.0	2 x 2	27	23.8	23	22.5	22	21	20	19	17.5	16	14
CTC-20/22M*	2.2	3.0	2 x 2	32	30	29.5	28.5	27.5	26	24	20 (21m³/h)			

* Flange type Connection

Note : The given performance data are common for both single phase & three phase. The last digit of the pump models "M" denotes Single phase and it will be replaced with "T" in case of three phase. In view of continuous developments the information / performance / descriptions / specifications / illustrations are subject to change without notice.

PERFORMANCE CURVES

CT SERIES

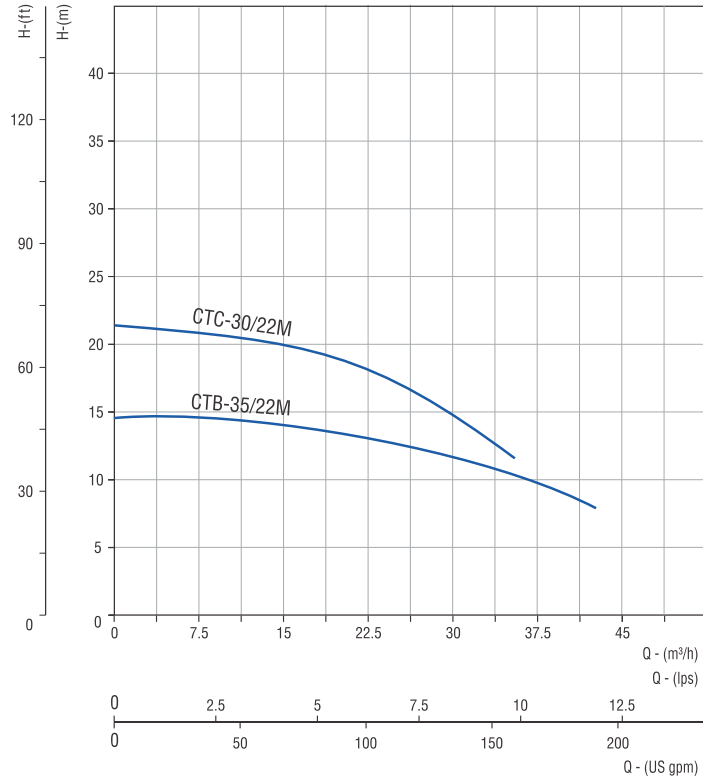

PERFORMANCE CHARTS

PUMP MODEL	MOTOR POWER		NOMINAL PUMP SIZE IN INCHES (Suc x Del)	DISCHARGE IN lps / m³/h									
				0.	2.8	4.17	5.56	6.94	8.33	9.72	11.11	12.5	
	kW	HP		0	10	15	20	25	30	35	40	45	
				TOTAL HEAD IN METRES									
CTC-30/22M*	2.2	3.0	2½ x 2	22	21	20	18.5	17.5	15	13	12 (36m³/h)		
CTB-35/22M	2.2	3.0	3 x 3	14.5	14.5	14	13	12.5	12	11	9	8 (42m³/h)	

* Flange type Connection

Note : The given performance data are common for both single phase & three phase. The last digit of the pump models "M" denotes Single phase and it will be replaced with "T" in case of three phase. In view of continuous developments the information / performance / descriptions / specifications / Illustrations are subject to change without notice.

PERFORMANCE CURVES

CT SERIES TWIN IMPELLER

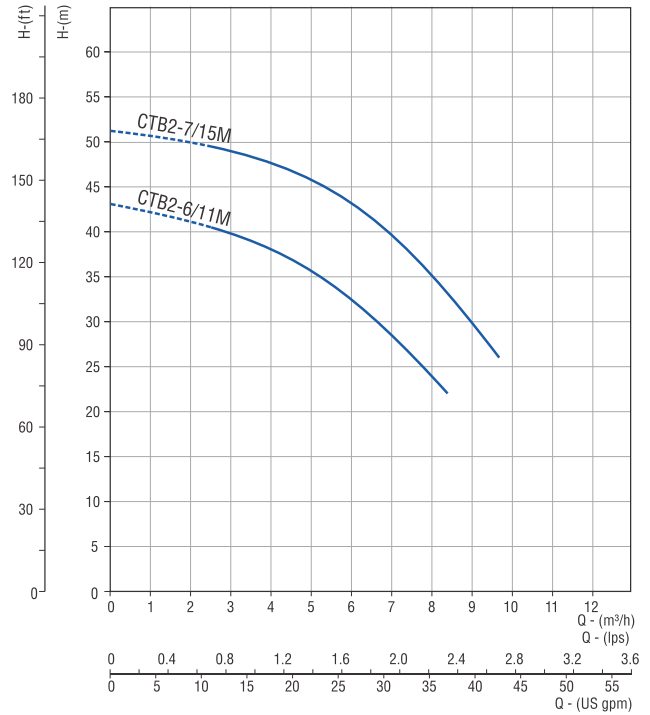
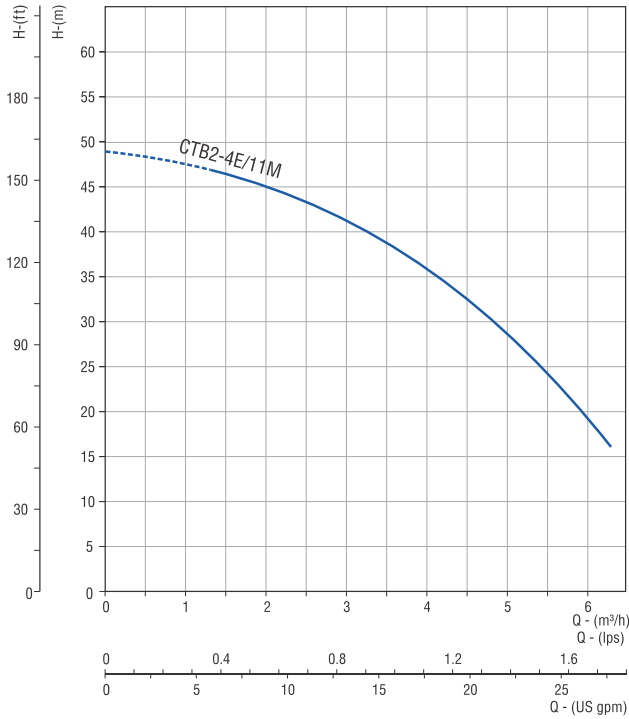

PERFORMANCE CHARTS

PUMP MODEL	MOTOR POWER		NOMINAL PUMP SIZE IN INCHES (Suc x Del)	DISCHARGE IN lps / m³/h									
				0	0.3	0.6	0.8	1.1	1.4	1.7	1.9	2.2	2.5
	kW	HP		0	1	2	3	4	5	6	7	8	9
CTB2-4E/11M	1.1	1.5	1½ x 1	49	48	45	41	36	28.5	20	16 (6.2m³/h)		

PUMP MODEL	MOTOR POWER		NOMINAL PUMP SIZE IN INCHES (Suc x Del)	DISCHARGE IN lps / m³/h								
				0	0.8	1.4	1.7	1.9	2.2	2.5	2.8	3.1
	kW	HP		0	3	5	6	7	8	9	10	11
CTB2-6/11M	1.1	1.5	1½ x 1	43	40	36	32.5	28.5	24	22 (8.4m³/h)		
CTB2-7/15M	1.5	2.0	1½ x 1	51	49.5	46	43.5	40	35.5	30	26 (9.6m³/h)	

Note : The given performance data are common for both single phase & three phase. The last digit of the pump models "M" denotes Single phase and it will be replaced with "T" in case of three phase. In view of continuous developments the information / performance / descriptions / specifications / Illustrations are subject to change without notice.

DIMENSIONAL DRAWINGS

CT SERIES

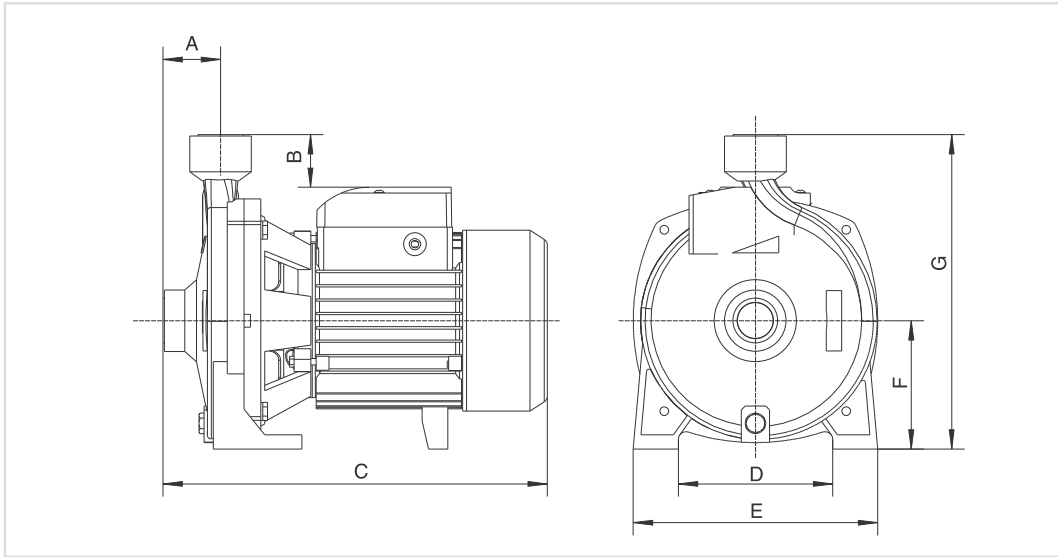

DIMENSIONAL DATA

PUMP MODEL	MOTOR POWER		A	B	C	D	E	F	G	APPROX. NETT WT IN Kg
	kW	HP								
CTS-4/03M	0.37	0.5	43	40	300	105	173	95	226	12.00
CTS-5/05M	0.55	0.75	57	45	315	120	192	98	242	13.00
CTS-6/07M	0.75	1.0	57	40	327	120	192	98	242	13.50
CTB-7/11M	1.1	1.5	53	50	354	150	234	117	286	33.50
CTB-8/15M	1.5	2.0	53	55	368	150	234	117	286	38.00
CTB-15/11M	1.1	1.5	60	61	378	94	196	110	278	21.20
CTB-18E/15M	1.5	2.0	60	61	378	94	196	110	278	23.50
CTB-35/22M	2.2	3.0	74	78	465	142	240	115	315	39.60
CTC-20/11M*	1.1	1.5	65	-	405	110	200	108	265	26.00
CTC-20/22M*	2.2	3.0	67	-	464	176	232	121	299	38.40
CTC-21F/15M*	1.5	2.0	70	-	430	104	200	108	270	28.60
CTC-30/22M*	2.2	3.0	75	-	440	104	200	108	280	28.75
CTB2-6/11M	1.1	1.5	80	30	400	142	225	115	270	20.50
CTB2-4E/11M	1.1	1.5	80	30	400	142	225	115	270	20.50
CTB2-7/15M	1.5	2.0	80	30	400	142	225	115	270	25.00

* Flange type Connection

* All Dimensions are in mm.